



**WARNING:** Please take the time to read through the ENTIRE instructions prior to starting any work. These instructions should be used in conjunction with the standard solar attic fan install instructions.

The Fire Safety Cutoff Switch is designed to help stop the spread of house attic fires during daytime fan operation by shutting down the Natural Light Solar Attic Fan. The switch includes a fusible link that will melt at 228° F and limit the introduction of fresh air that would otherwise feed the fire.

**IMPORTANT:** If you are also installing the Natural Light Thermal Switch, the Fire Safety Switch needs to be installed first and the Thermal Snap Switch attaches to the Fire Safety Switch. Begin with the Fire Safety Cutoff Switch Installation (Steps 1 to 5b) then proceed to Step 5 on the Thermal Switch Installation.

**CAUTION:** IF WORKING OUTSIDE, COVER THE SOLAR PANEL WITH A SOFT CLOTH TO PREVENT THE FAN FROM OPERATING WHILE HANDLING THE UNIT.

## PARTS

- Fire Safety Switch
- 1/8" Allen Wrench
- Zip Tie

## TOOLS NEEDED

- Soft Cloth or Cardboard
- Scissors

### STEP 1

Ensure that the solar panel is locked in the flat position. Carefully turn the unit upside down and place it gently on a soft cloth or piece of cardboard to prevent scratching the solar panel.

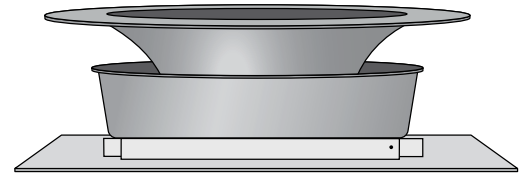

### STEP 2

Using the provided 1/8" Allen Wrench, remove the set screw holding the fan blade in place to the motor shaft. Carefully slide the fan blade up and off of the motor shaft. Place the fan blade and set screw off to the side.

**NOTE:** Take care not to damage the fan blade.

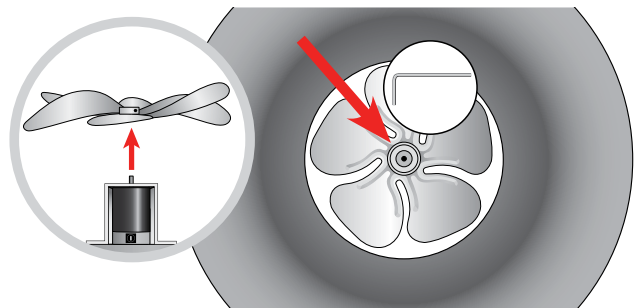

### STEP 3

Locate the wire lead coming from the motor and disconnect the red female wire by sliding it off of the male motor connector. Then, plug it into the black male connector on the fire safety cutoff switch wire.

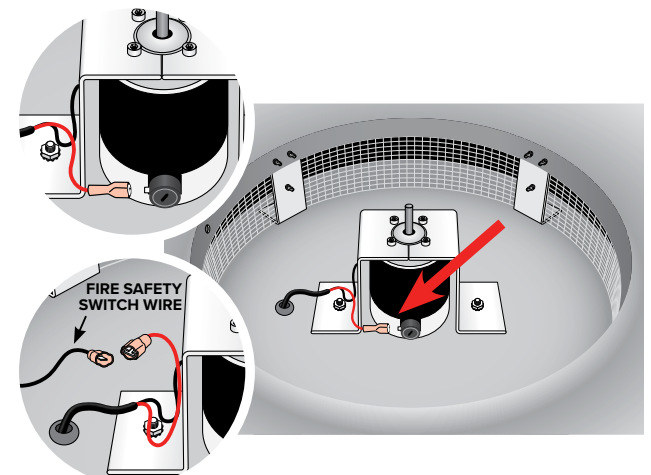
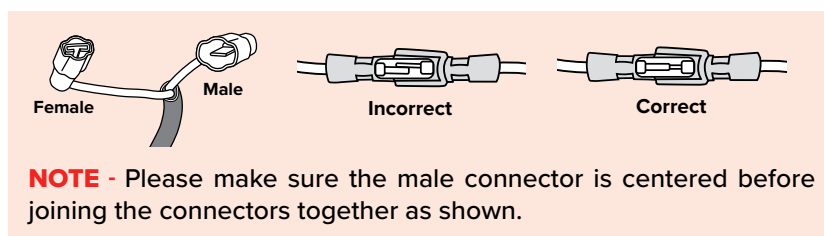

#### STEP 4

Insert red female connector from the fire safety cutoff switch into the open male connector on the motor.

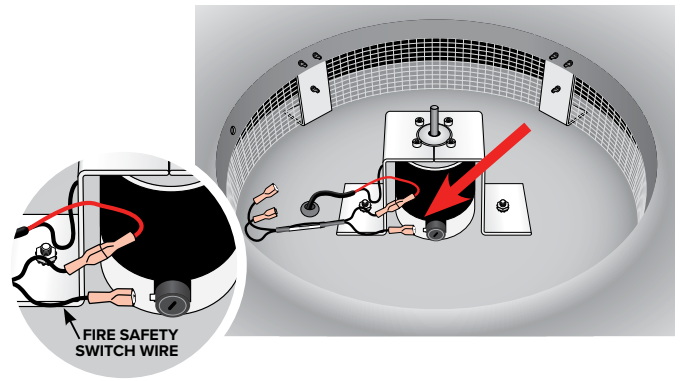

#### STEP 5A - INSTALLING ONLY A FIRE SAFETY CUTOFF SWITCH

Connect the male and female connectors together on the other end of the fire safety switch creating a closed loop.

*Continue to Step 6 below.*

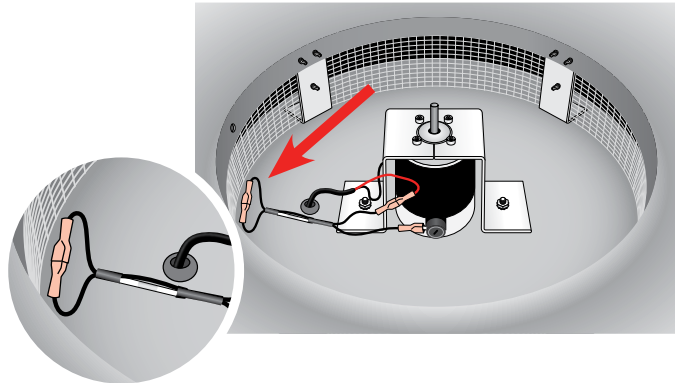

#### STEP 5B - INSTALLING BOTH A FIRE SAFETY CUTOFF SWITCH AND THERMAL SWITCH

Insert the male plug from the thermal switch into the female plug on the fire safety cutoff switch. Then insert the male plug from the fire safety cutoff switch to the red female plug on the thermal switch.

*Continue to Step 5 on the Thermal Switch Installation.*

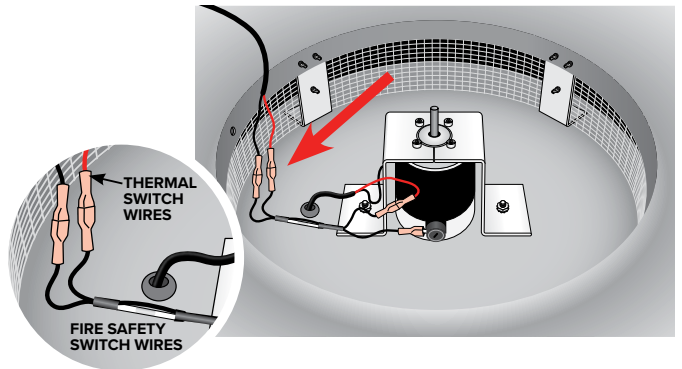

#### STEP 6

Using the provided zip tie, neatly wrap the loose wires together to ensure that the fan blade will clear the wires. Snip off the excess plastic on the zip tie.

**IMPORTANT:** All wires must be secured and out of the way of the fan blades to avoid damaging the wires.

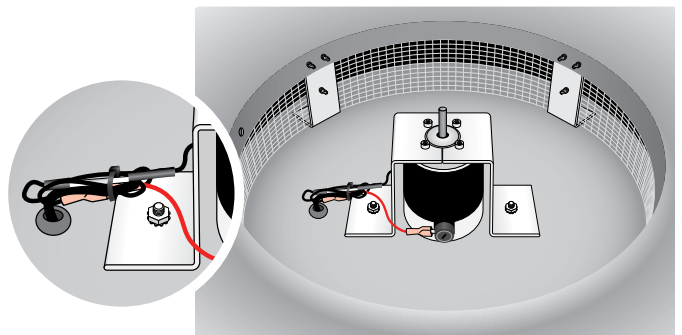

#### STEP 7

Replace the fan blade by sliding it over the motor shaft. Make sure that the end of the motor shaft is flush with the fan hub. Tighten the set screw using the provided 1/8" Allen Wrench.

Continue with the solar attic fan installation instructions.

