



WARNING: Please take the time to read through the ENTIRE instructions prior to starting any work. Not following the instructions will invalidate the warranty.

Warnings & Precautions:

- Ensure normal safety precautions are taken when using tools, ladder and walking on roofs.
- Repair only in dry weather.
- Wear eye protection and follow safety procedures recommended by saw manufacturer.

Tools Needed:

- 1/8" Allen Wrench
- 3/8" Standard Wrench
- 7/16" Crescent Wrench
- 7/16" Socket Wrench
- Phillips Head Screwdriver
- Gloves

Gable Fan Components:

- Gable Flashing
- Gable Ring
- Motor Bracket
- Motor
- Fan Blade
- Wires with connectors

Natural Light Energy Systems • 10821 N 23rd Ave, Phoenix AZ, 85029 • 1.800.363.9865 • www.nltubular.com

Step 1: Deactivate the fan by gently unplugging the "pigtail" wire connectors. (These connectors are for use if the optional Fire Safety or Thermal Switch sensor has been requested.)

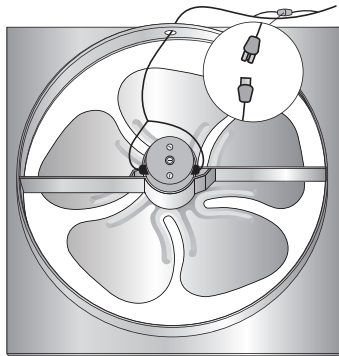

Step 2: After the fan blade stops spinning, disconnect the positive (red) wire and negative (black) wire from the motor.

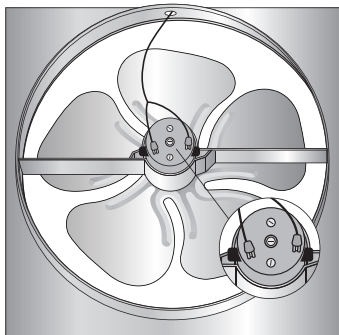

Step 3: Use the Phillips Head Screwdriver to remove the four screws (at the 12, 3, 6, and 9 o'clock positions) from the base of the Gable Ring.

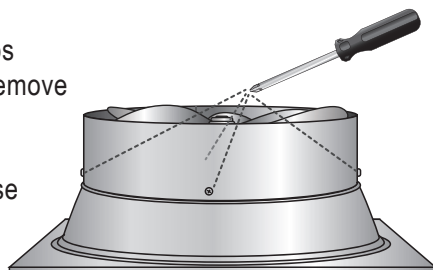

Step 4: Loosen but don't fully remove the two screws which are found opposite the wiring on the Gable Ring.

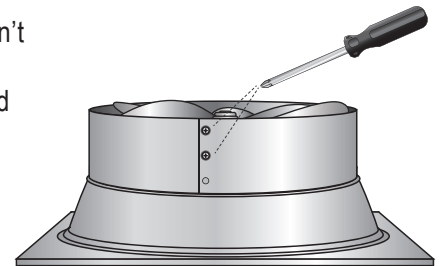

Step 5: Carefully remove the Gable Ring from the Gable Flashing.

WARNING: Metal pieces are sharp.

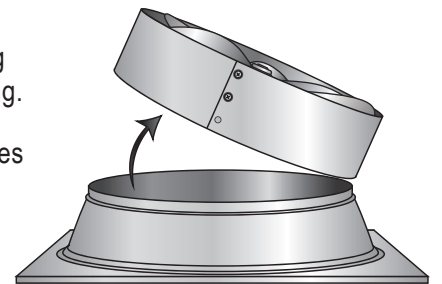

Step 6: Set Gable Ring on a flat surface with the fan facing up.

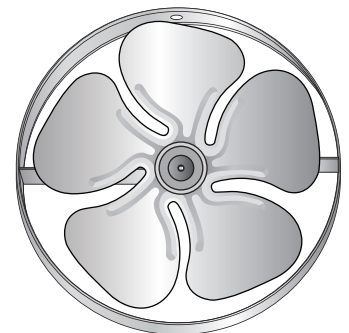

Step 7: Using the provided 1/8" Allen wrench, loosen the fan blade from the motor spindle, then remove the fan blade.

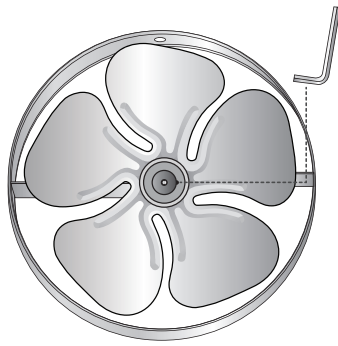

Step 8: Using a Crescent wrench and a Socket wrench, loosen (but don't remove) the two hex bolts on both sides of the motor bracket.

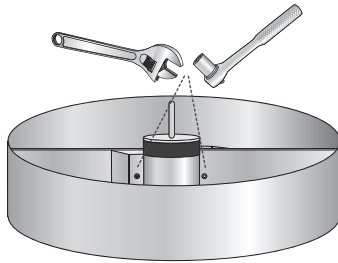

NOTE: Observe how the old motor sits inside the bracket, and remove the old motor.

Step 10: Replace with the new motor, making sure that the top of the new motor's spindle side extends approximately 5/8" above the motor bracket. (This is to ensure that the fan blade won't come in contact with the bracket.)

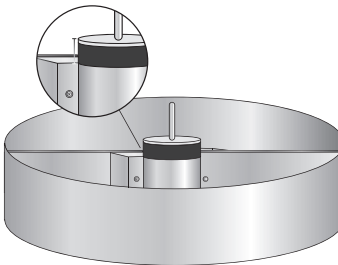

Step 11: Use the Crescent and Socket wrenches to retighten the two motor bracket bolts, so that the brackets are securely in contact with each other.

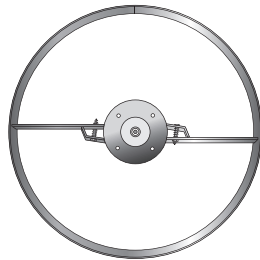

Step 12: Place the fan blade on the motor spindle with the hub side up.

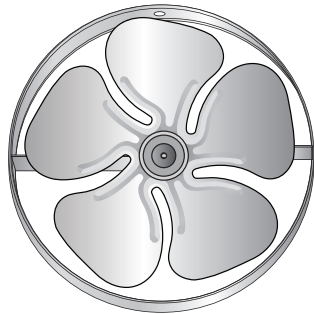

Step 13: Use the Allen wrench to tighten and secure the fan, leaving only 1/8" of the spindle showing above the hub.

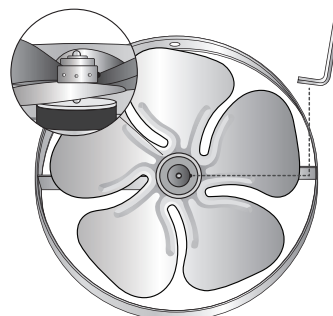

Step 14: Place the Gable Ring back on the Gable Flashing, being careful to match the hole pattern for the four screws.

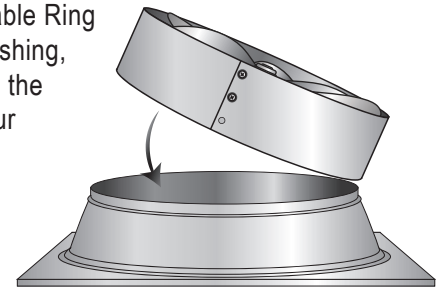

Step 15: Tighten the two screws (loosened but not removed in Step 4) which are found opposite the wiring on the Gable Ring.

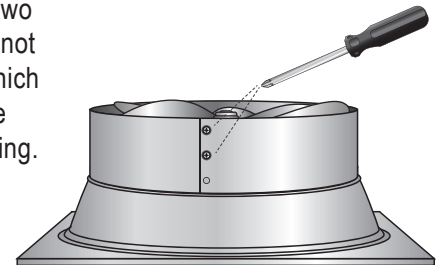

Step 16: Replace and tighten the four Gable Ring screws (in the 12, 3, 6, and 9 o'clock positions).

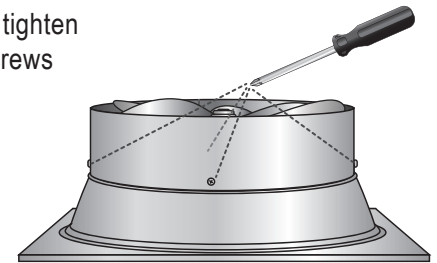

Step 17: Reconnect the positive and negative wire connectors to the motor with the red wire going to the red tab side and the black wire going to the black tab side.

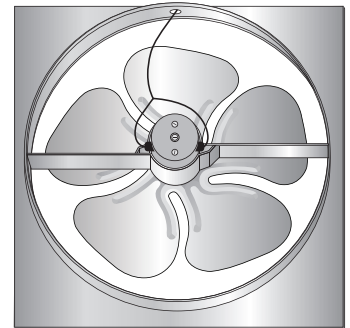

Step 18: Finally reconnect the pigtail connectors (from Step 1) to resume fan rotation.

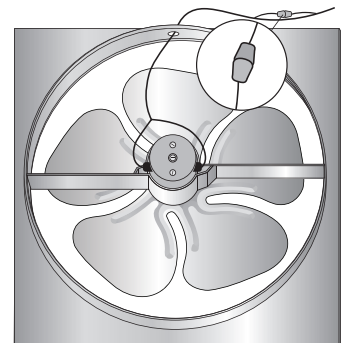

Natural Light Energy Systems
10821 N 23rd Ave, Phoenix AZ, 85029
1.800.363.9865 | www.nltubular.com